



1511 Hancel Parkway Mooresville, IN 46158 317-837-2444

Transmission Crossmember '99~'04 Mustang

**For C4, TH-350, PowerGlide, T-5, TKO's, AOD, AODE, 4R70W, T-45, TR-3650, T-56*, TH-400
& T-45(Cobra Spec) Transmissions
(TCB-M20)**

The adjustable design of this crossmember works with numerous transmission applications in your '99-'04 Mustang or Cobra, all while maintaining your current pinion angle. The low profile design offers more exhaust clearance than the OEM crossmember, in a sleek, lightweight package. The factory rubber mount is replaced by polyurethane bushings for a firmer shift while still damping driveline vibrations and noise.

***Does not work with T-56 Viper Spec or GT500 Spec**

Kit Includes:

- | | | | |
|---|---------------------------|---|----------------------|
| 1 | Transmission Crossmember | 2 | Black Poly. Bushings |
| 4 | 10x1.5x40 Hex Head Bolts | 2 | Red Poly. Bushings |
| 4 | M10 Flat Washers | 2 | Thin Spacer (.125") |
| 2 | 1/2-13x2.5 Hex Head Bolts | 2 | Thick Spacer (.250") |
| 4 | Large 1/2 Washers | 2 | Sleeves |

Required Tools: Basic hand tools
Floor jack
Jackstands

Install Time: Approximately 1 hr

Installation:

1. Raise vehicle to allow access for installation; support with jackstands.
2. Support transmission with floor jack. Do not place jack on transmission pan or block access to crossmember mounts.
3. Remove the two bolts (B) securing OEM crossmember to the transmission. (Fig1)
4. Remove four bolts (A) connecting crossmember to body mounts. (Fig1)
5. In **Table1**, locate your transmission, choose which install option (With or Without Stiffeners Driveshaft Safety Loop) and note the correct picture number for your installation.
6. Locate the picture chosen in Step#5, and assemble the bushings, washers, and sleeves as shown. Loosely install to transmission with supplied bolts.

NOTE: Pay close attention to the installation picture! The crossmember can be installed either facing up or down depending on your application.

7. Refer to **Table 1** and confirm spacer thickness (if required). **Insert spacer between body and crossmember(C)**(Fig1). Slightly raise transmission if more clearance is needed to input spacers.
8. Using supplied bolts and the **remaining set of spacers as washers**, fasten crossmember to body. **Final tighten these four bolts.** (Fig.2) Lower and remove jack supporting transmission. **Final tighten the two transmission bolts.** (The bushings will compress and the washers will tighten up against the sleeve.)
9. Remove jackstands and lower vehicle.



TCB-M20

www.BuyStiffeners.com

Page 1

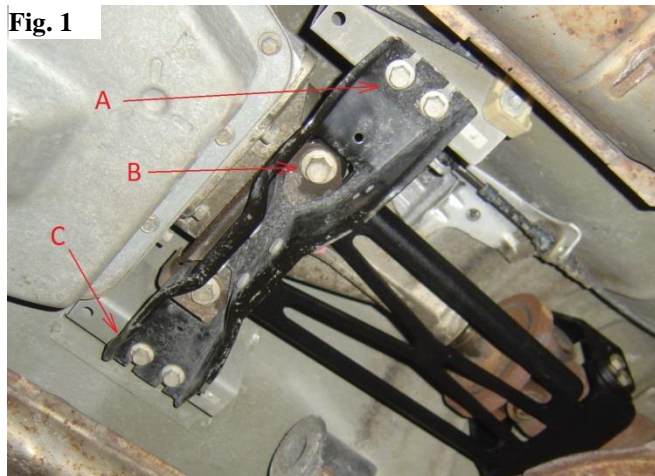

Example Install of TR-3650 with Stiffeners Loop

PLEASE READ THIS:

This crossmember is designed to cover many different applications and can be installed in four different directions depending on your application. **Pay close attention to the installation picture! The crossmember can be installed either facing up or down. Rotate crossmember as needed to fit your transmission.**

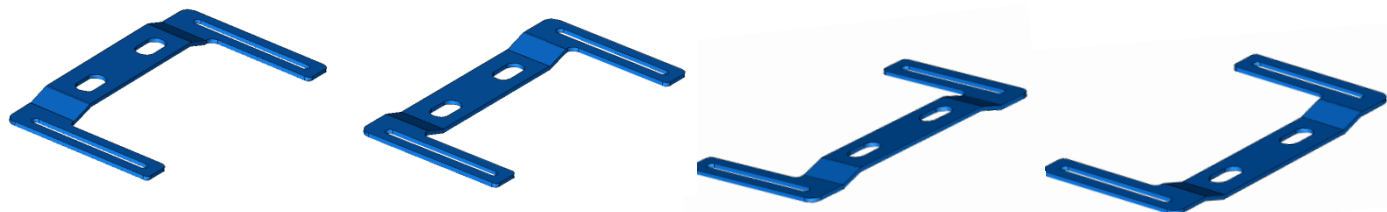

Table 1

Transmission Type	<u>Without</u> Stiffeners Driveshaft Loop		<u>With</u> Stiffeners Driveshaft Loop	
		Spacer		Spacer
TKO's, TR-3550, POWERGLIDE, TH350	Pic# 1		Pic# 7	
TH400	Pic# 2	Thin	Pic# 8	Thick
T-56 XL, C4	Pic# 3	Thin	Pic# 9	Thin
TR-3650, T-45, T-5, AOD, AODE, 4R70W	Pic# 4		Pic# 10	Thin
T-56 MAGNUM, TR-6060, T-45(Cobra Spec)	Pic# 5	Thin	Pic# 11	Thick
T-56	Pic# 6	Thick	Pic# 12	Thick (x2)

THESE ARE SUGGESTED SETTINGS, YOURS MAY VARY.

Pic. 1



Pic. 2



Pic. 3



Pic. 4



Pic. 5



Pic. 6



Pic. 7



Pic. 8



Pic. 9



Pic. 10



Pic. 11



Pic. 12



Use .250" spacers from Safety Loop Kit in addition to the Thick spacers supplied here.