

UPR Dual Valve Oil Catch Can Installation 2021 Ford Bronco 2.7

PDF Instructions also available at UPRProducts.com

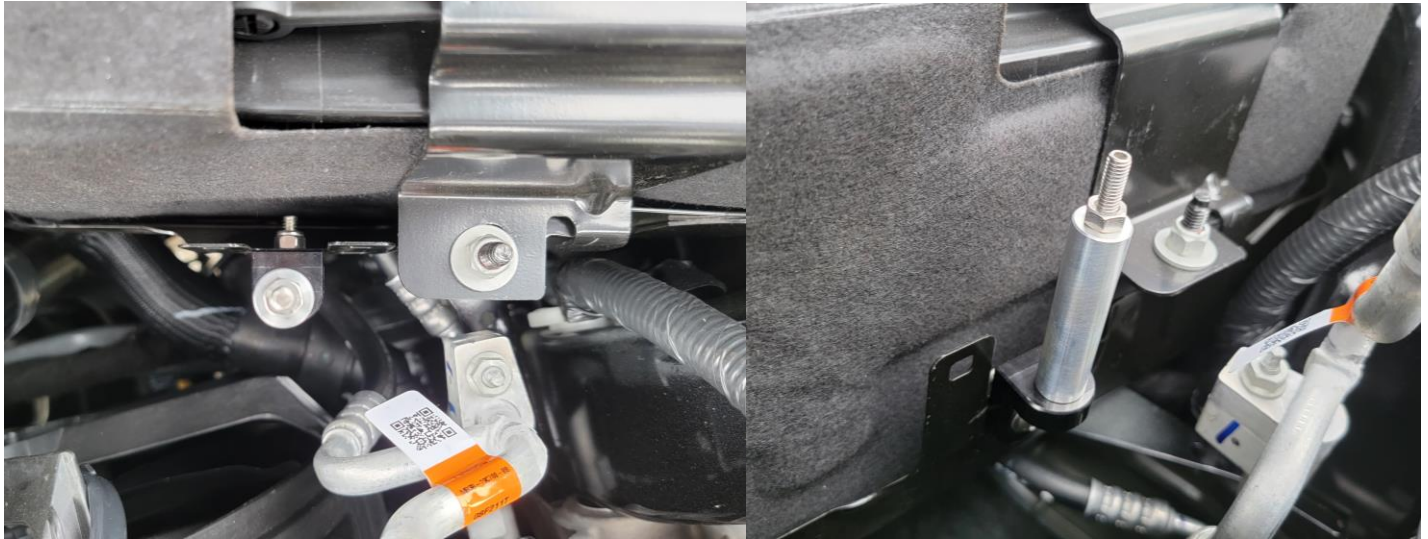

1. Using the supplied hardware, attach the UPR billet catch can mounting bracket to the middle hole at the front of the battery tray. To make this easier, you can remove the battery hold down bracket which will allow you to move the battery slightly.

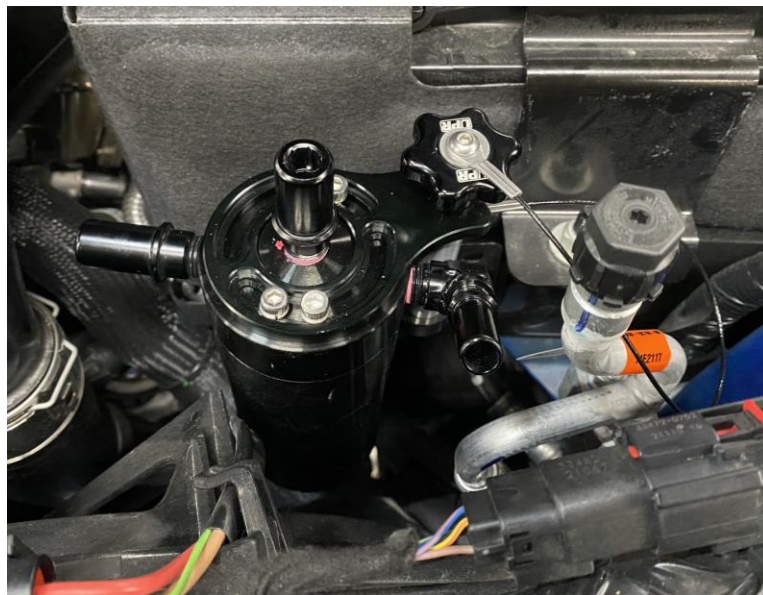

2. Attach the catch can to the UPR billet bracket with the supplied knob. You can leave the catch can slightly loose to allow adjustment when routing hoses. The allen screws at the top of the catch can allow for adjustment as well. Once the hoses are routed, adjust the catch can for best fit and tighten fasteners.

Be sure to shop our online store for the best deals: www.uprproducts.com



3. Locate the U shaped PCV hose and remove it by releasing the quick release fittings.

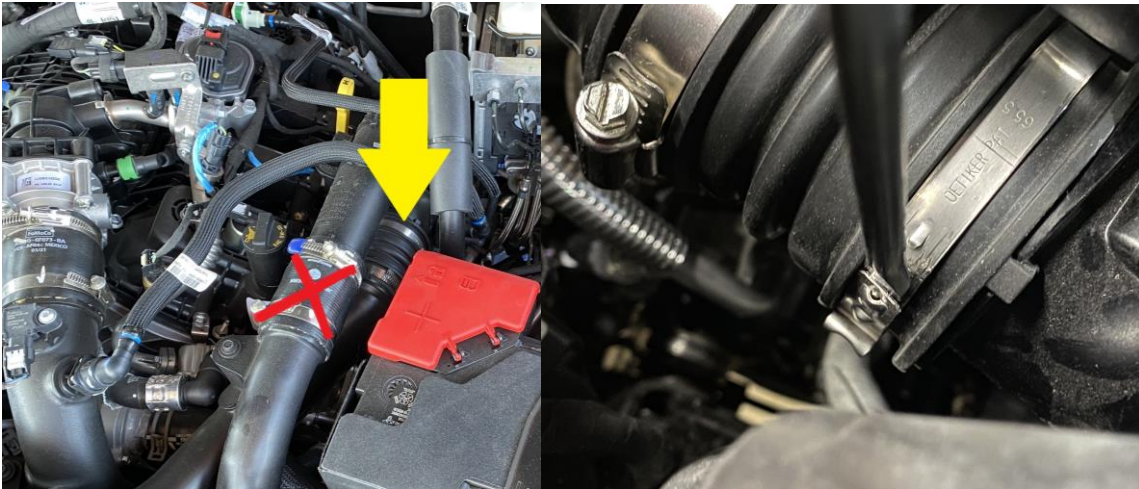

4. Locate the Driver Side Cold Side Turbo inlet coupler (Arrow). Unscrew the clamp on one side and use a flat screwdriver to pry off the crimped clamp on the other.

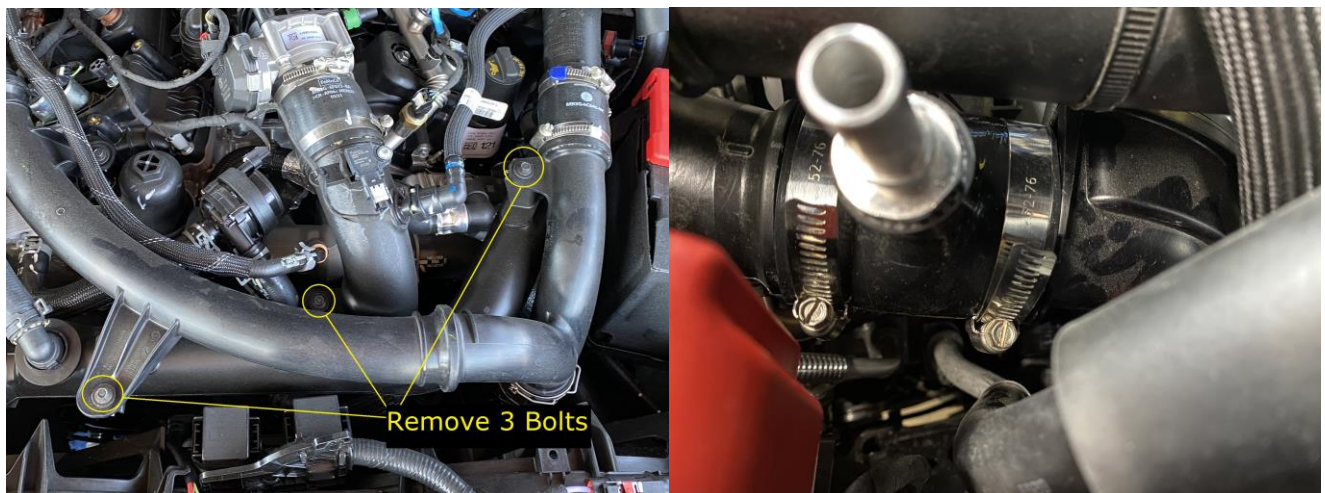

5. Remove the 3 bolts securing the cold side pipe. Slide the pipe forward, remove the coupler and replace it with the UPR coupler. Secure it with the provided clamps.

Be sure to shop our online store for the best deals: www.uprproducts.com

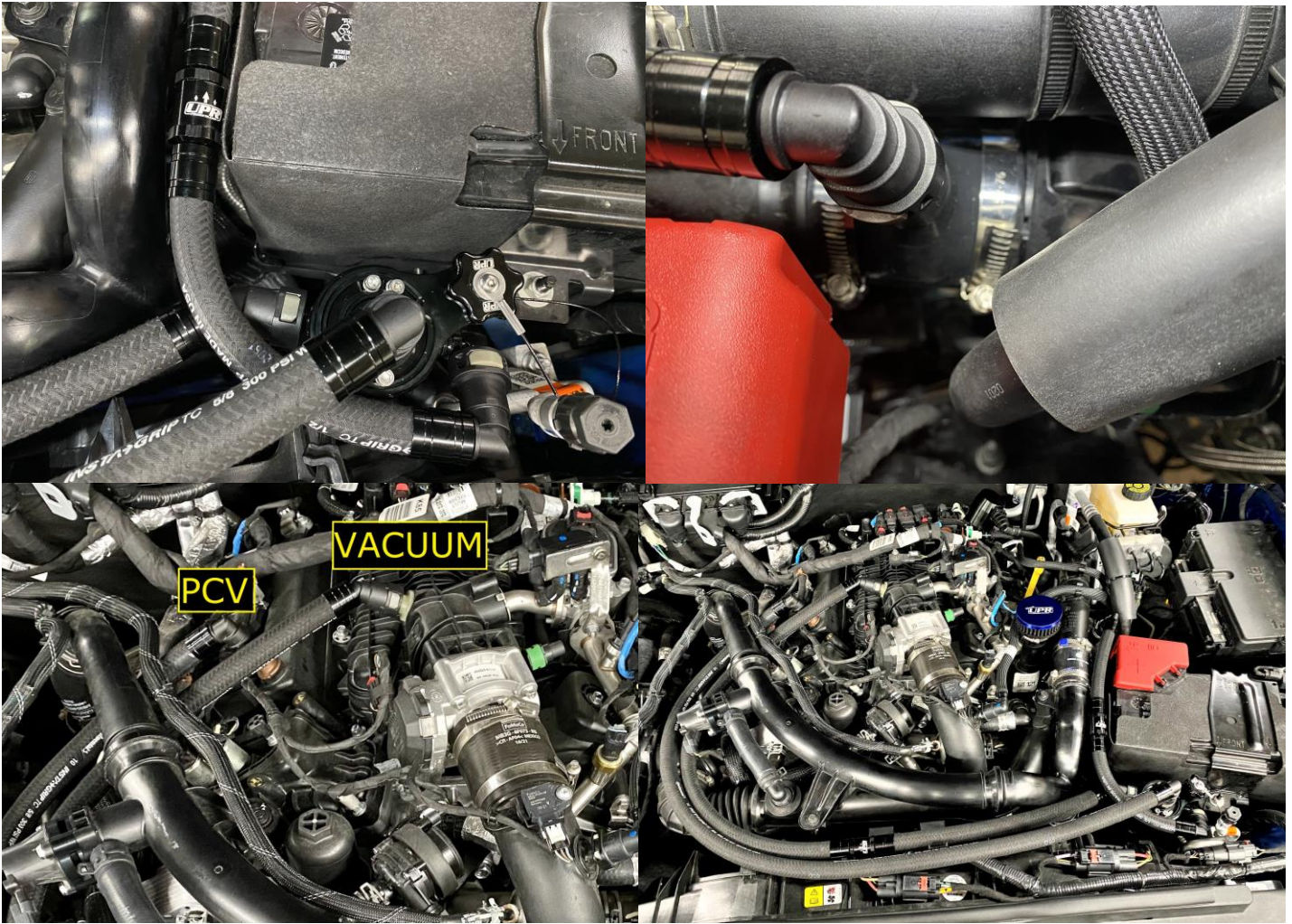

6. Connect the hose with 45 degree fittings from the side of the catch can to the intake manifold vacuum port. Connect the short hose from the other side of the catch can to the fitting on the UPR coupler. **Be sure the Arrows printed on the check valves face away from the catch can.** Connect the long hose with 90 degree fittings from the PCV valve on the passenger valve cover to the top of the catch can. You can secure the hoses if desired with zip ties, but if routed as shown they will be secure.

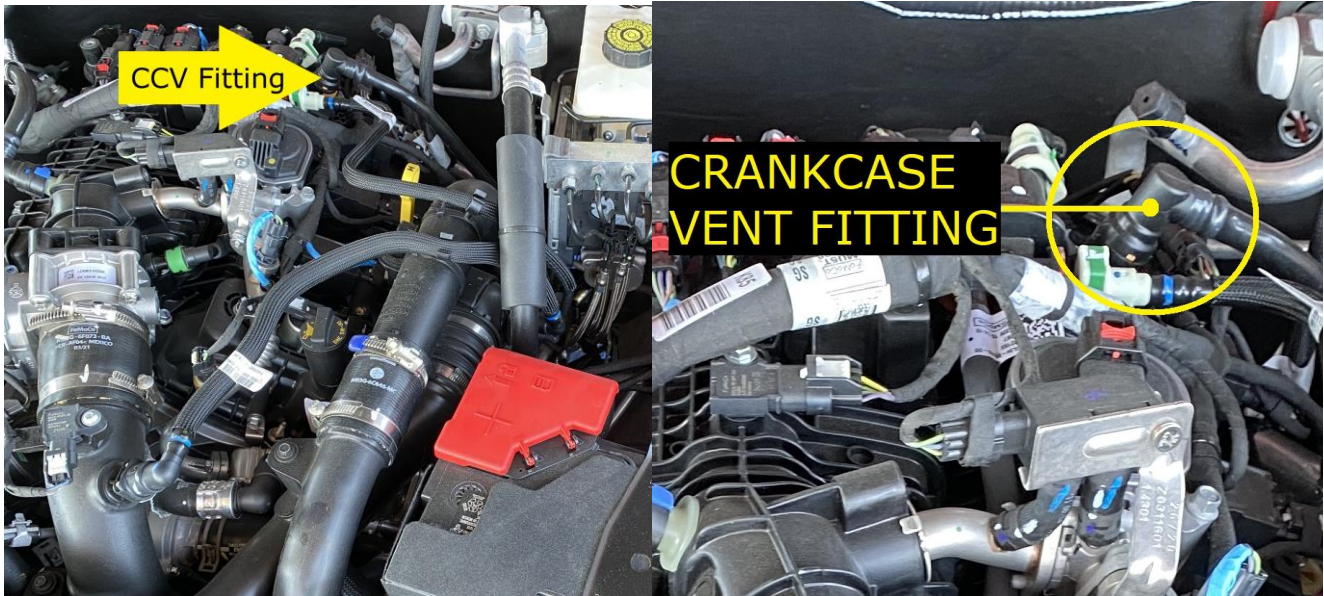

7. Locate the Crankcase Vent (CCV) Fitting at the back of the driver side valve cover.



8. The orange fitting does not have a quick release. To remove it, use an adjustable wrench or 1 1/16" claw foot wrench to turn the CCV fitting on the valve cover counter clockwise about 1/2 turn and lift it off.

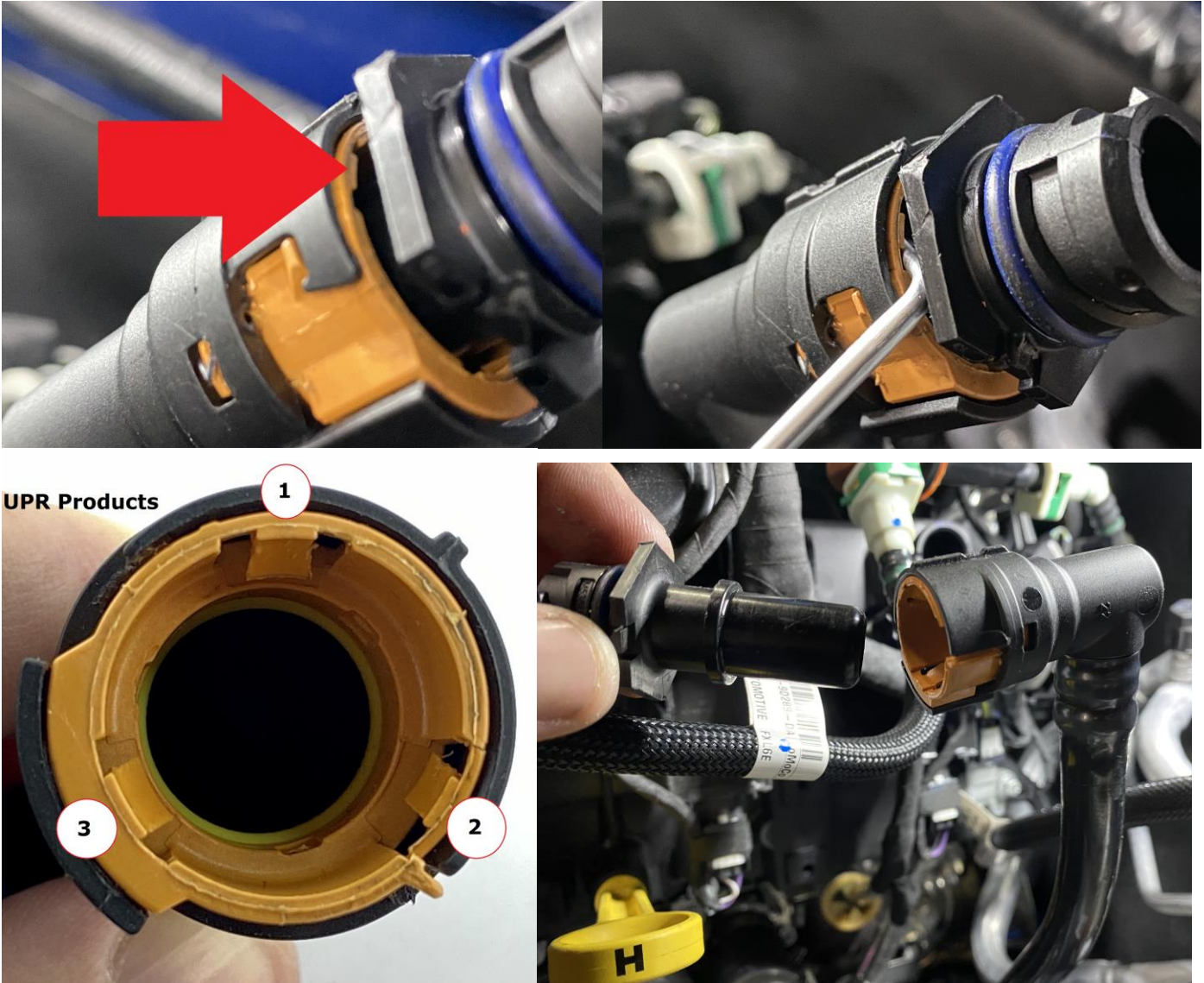

9. Once the CCV fitting is removed, You will need a 90 degree pick to depress the 3 tangs on the orange fitting. While depressing the tangs, you will need to apply light outward pressure to the CCV fitting as if you are trying to pull it out. This way, once the tangs are pressed the fitting can come out.

9B. Another method to remove the fitting is to separate the orange portion of the fitting from the outer cover. Using a pick or flat screwdriver, find the small orange 'window' on each side of the fitting. Slide the pick or screwdriver up between the black outer portion of the fitting and the orange inner portion. Pry up on each side to pop the outer portion off.



Now that you can see the 3 tangs, while applying upward pressure, use a pick or small screwdriver to release them.

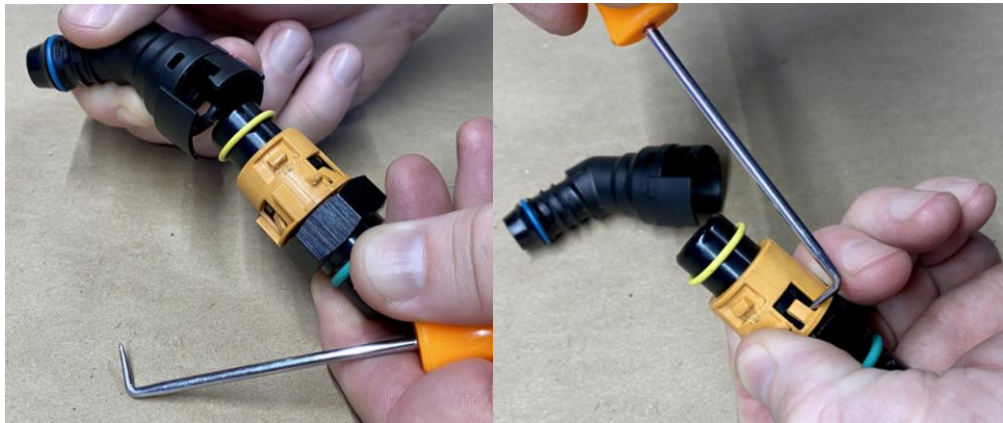

It is very common to break the tangs on the orange fitting when removing it. UPR Has Plug N Play replacement fittings that can replace the OEM non removable fitting. To replace the fittings on your factory CCV tube, use a heat gun or lighter to gently warm the plastic tube – do not melt or burn the tube. Pull the fitting out of the tube once it is warm, (be careful, it will be hot) and insert the new fitting into the tube while it is still warm. The tube will conform to the fitting as it cools. To assist, you can wrap a small zip tie around the tube ends while they cool.





10. Reinstall the CCV fitting onto the valve cover. To install the Clean Side Separator (CSS) pull up on the collar at the base of the CSS and push it down onto the CCV fitting. Once the CSS is installed fully onto the CCV fitting, the collar will click on to secure it. Rotate the fitting on the CCV tube and click it onto the CSS fitting.

The UPR catch can is easily serviced by removing the quick release knob, releasing the quick release fittings by pressing the grey buttons (**never** pry the buttons out) and disconnecting the hoses. Unscrew the catch can cup and dispose of the contents with used waste oil and dispose waste oil according to your local laws. The catch can and components are easily washed with warm water and dish soap. If need be, the catch can and components can be removed and the vehicle can be returned to stock for dealer service.

Always check and drain the catch can more often in winter / freezing weather. If the water/oil mixture in the catch can is allowed to freeze it will cause damage to the catch can and catch can components. Any damage due to freezing is NOT WARRANTY. You must dispose of the liquid collected in the catch can properly (with used waste oil) properly according to your local laws.

Product Liability Statement: The purchase of the product, manufactured by UPR Products Inc. completes an agreement between UPR Products Inc. and the customer. UPR Products Inc. assumes no liability for damages or injury incurred by the buyer of this product. The purchaser or user of this product is responsible for the proper disposal of any hazardous materials (oil catch can contents). The buyer has complete responsibility for the installation, use and upkeep of this product.