

UPR Oil Catch Can Installation

2021 Ford F150 2.7L & 3.5L Ecoboost Dual Valve Catch Can No Drill (Does not fit Hybrid)

1. Remove the factory air filter box or cold air box inlet to gain access to the catch can mounting point.



2. Locate the oval shaped hole in the frame on the driver side directly below the air inlet. Install the 90 degree mounting bracket to the frame with the supplied hardware. The bracket should be facing upwards as shown. Install the catch can onto the bracket with the supplied hardware.

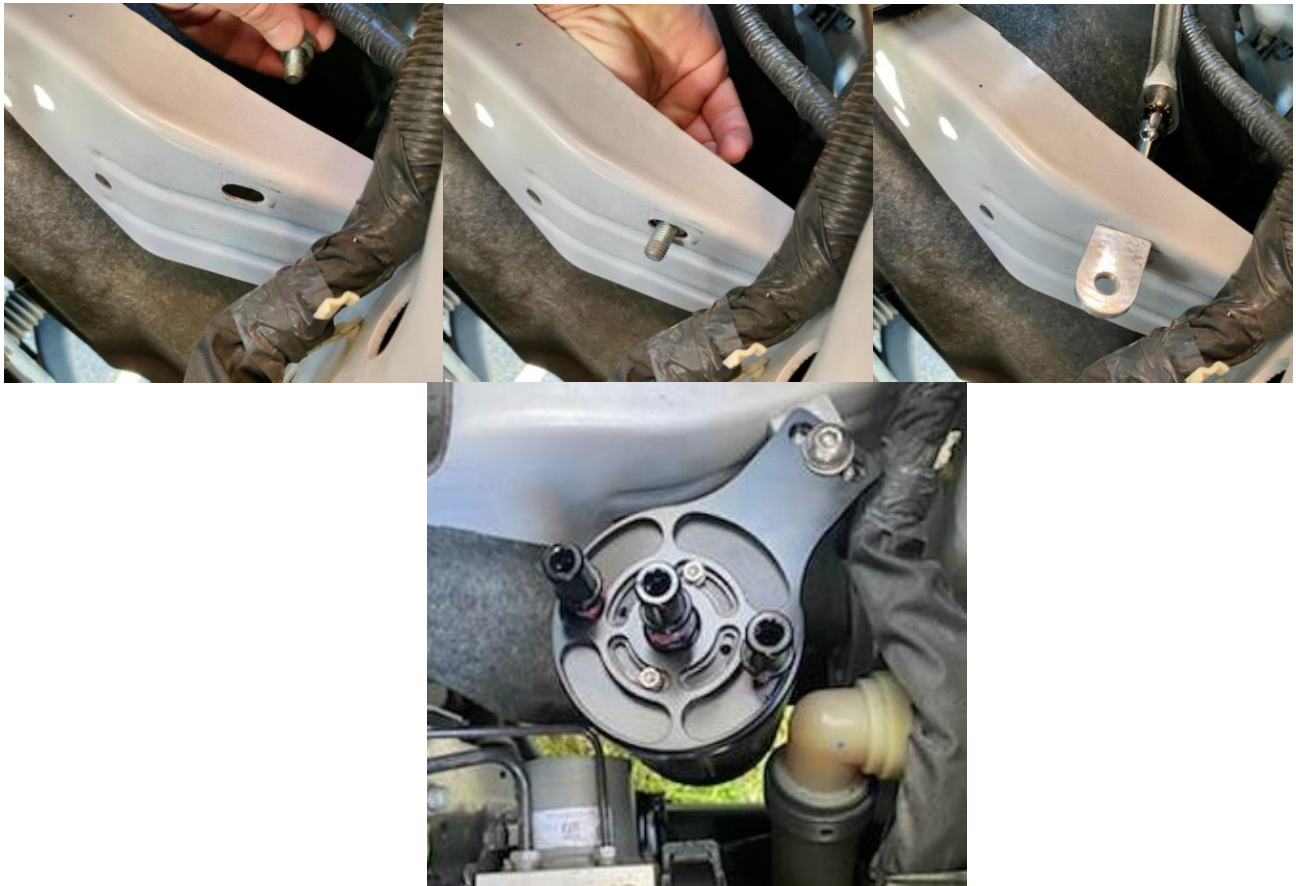

* *Optional 4" MEGA catch can shown, positioning for standard 3" can will be the same.*

Be sure to shop our online store for the best deals: www.uprproducts.com

5. Time to start routing hoses. Connect the hose with no check valve in it to the passenger valve cover PCV valve and route it to the catch can center inlet port. Be sure to route hoses so they will not contact any belts, pulleys or other hazards. Find the longest hose in the kit with a check valve in it. Route the hose so that the arrow printed on the check valve faces away from the catch can, towards the engine. Connect the hose to the intake manifold vacuum port, and the other end to the outlet port that is furthest forward on the catch can. Route the short hose towards the driver side of the engine.

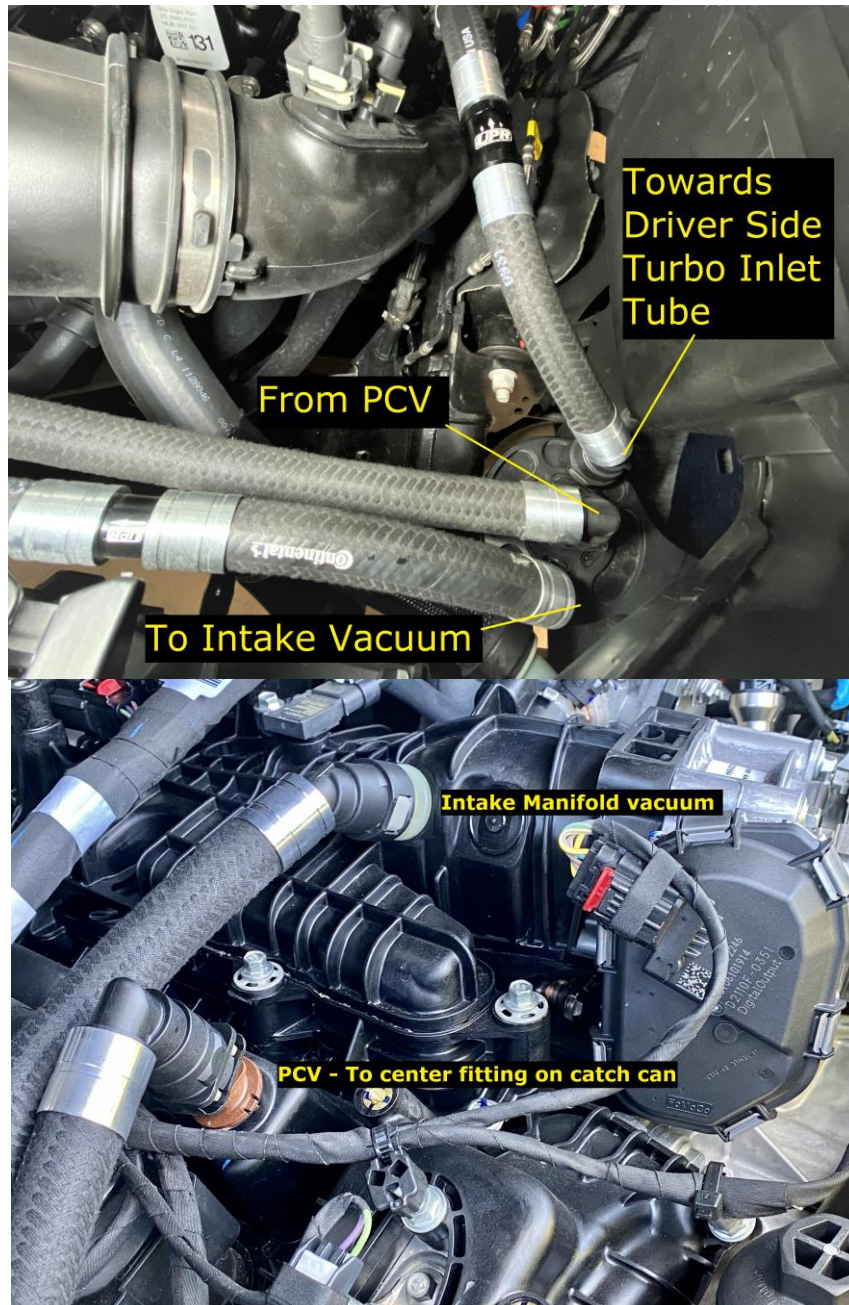

6. On the 2021 2.7L and 3.5L EcoBoost F150s, the driver side CCV (Crankcase Vent) hose is secured with special orange fittings. There is no tool available through Ford to remove this fitting. To install the Clean side catch can, and WOT (Wide Open Throttle hose) you will need to remove these fittings.

You can use a 90 degree pick or hook pick to either disassemble the fitting or attempt to release the 3 tangs in the fitting, which is not easy. Most likely, you *will* break the orange fittings. That's ok, because UPR supplies replacement quick release fittings in the kit if you want to put your truck back to stock. See below for instructions on how to remove the fittings, repair your factory CCV tube, and install the Clean Side Catch Can and WOT fitting.

2.7L: The 2.7L EcoBoost engine has a removable Crankcase Vent (CCV) Fitting at the back of the driver side valve cover. The 3.5L does not have a removable fitting.

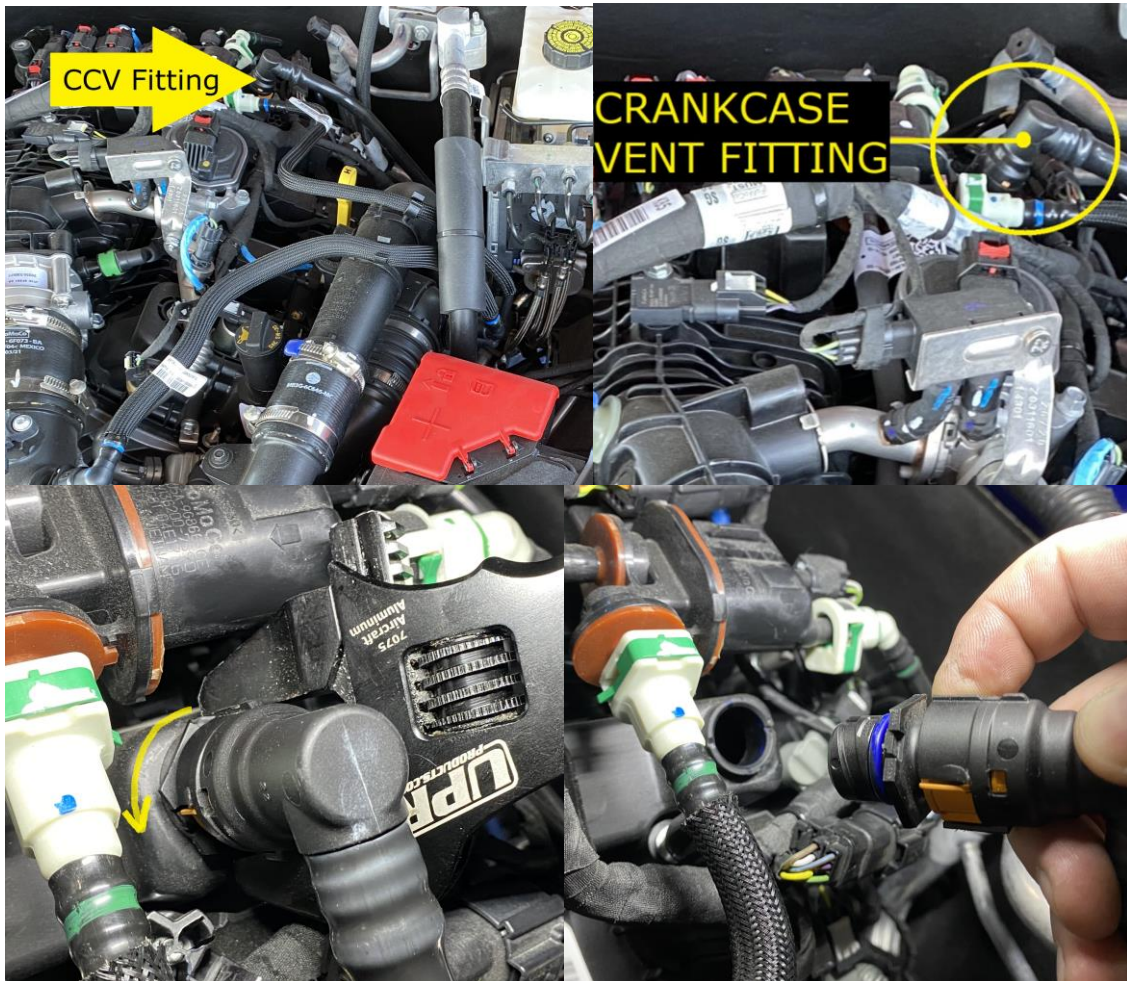

The female orange fitting does not have a quick release mechanism. To remove it, use an adjustable wrench or 1 1/16" claw foot wrench to turn the CCV fitting on the valve cover counter clockwise about ½ turn and lift it off.

Be sure to shop our online store for the best deals: www.uprproducts.com

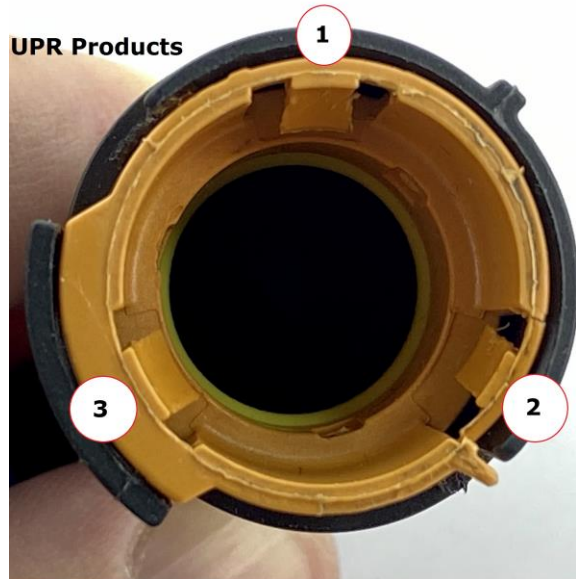

Once the CCV fitting is removed from the valve cover, You can rotate it to get a better view. Use a 90 degree pick to depress the 3 tangs on the orange fitting. While depressing the tangs, you will need to apply light outward pressure to the CCV fitting as if you are trying to pull it out. This way, once the tangs are pressed the fitting can come out.

3.5L: Use a 90-degree pick or hook pick to release the fitting. There are 3 little tabs securing the female end of the fitting onto the valve cover fitting.

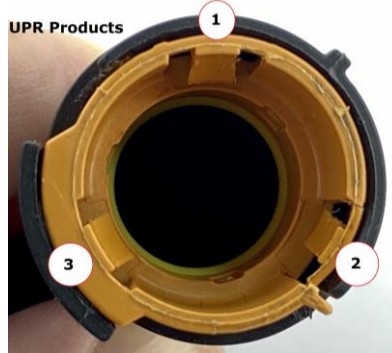

While holding the hose and applying slight upward pressure, run the pick under the fitting to release the tabs. If the fitting or tabs break, the fitting can be replaced with a standard UPR Plug and Play fittings P/N 2025-39 (straight), 2025-40 (90 degree) or 2025-41 (45 degree).

Repeat the process to remove the fitting at the other end of the tube.



Be sure to shop our online store for the best deals: www.uprproducts.com

Another Method to remove the fitting is to separate the orange portion of the fitting from the outer cover. Using a pick or flat screwdriver, find the small orange 'window' on each side of the fitting. Slide the pick or screwdriver up between the black outer portion of the fitting and the orange inner portion. Pry up on each side to pop the outer portion off.



Now that you can see the 3 tangs, while applying upward pressure, use a pick or small screwdriver to release them.

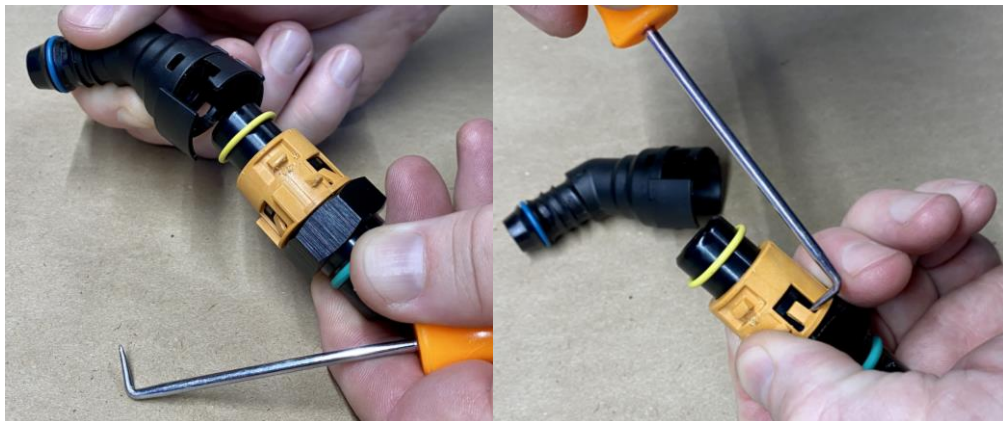

To replace the fittings on your factory CCV tube, use a heat gun or lighter to gently warm the plastic tube – do not melt or burn the tube. Pull the fitting out of the tube once it is warm, and insert the new fitting into the tube while it is still warm. The tube will conform to the fitting as it cools. To assist, you can wrap a small zip tie around the tube ends while it cools.



Be sure to shop our online store for the best deals: www.uprproducts.com

Clean Side Catch Can and WOT fitting:

Install the 3-way Plug N Play Wide Open Throttle adapter fitting onto the turbo inlet tube so that the female leg of the Tee is facing forward. Connect the male fitting on the WOT hose from the catch can to the female fitting on the Tee.

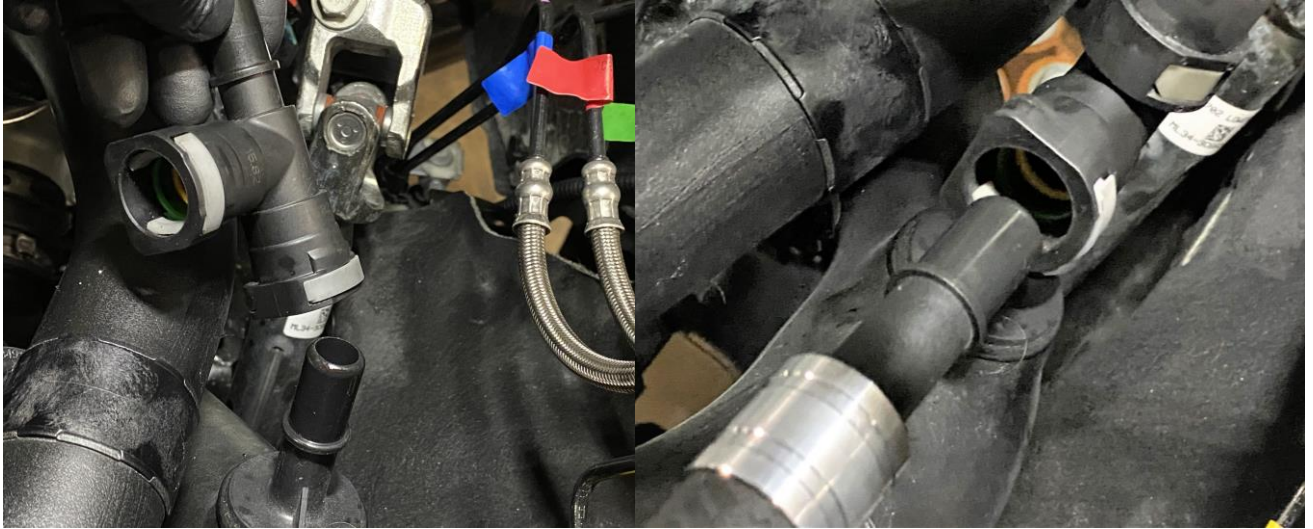

Remove the 10MM nut on the ABS brake controller bracket. Install the UPR Clean Side Catch Can bracket and reinstall the nut. You may bend the bracket slightly to allow the catch can to sit level.



Install the longer hose with the 90 degree fitting onto the driver side valve cover CCV fitting, and connect the other end of the hose to the rear fitting on the clean side catch can.



Install the shorter hose that has 45 degree fittings onto the front fitting on the clean side catch can, then connect it to the male fitting on the 3 Way Tee.



Go back through and check all connections. Check the catch can about every 1000 miles until you get a good feel for what your engine will expel. Most will need to service the catch can at oil change intervals.

. Product Liability Statement: The purchase of the product, manufactured by UPR Products Inc. completes an agreement between UPR Products Inc. and the customer. UPR Products Inc. assumes no liability for damages or injury incurred by the buyer of this product. The buyer has complete responsibility for the installation, use and upkeep of this product.

Always check and drain the catch can more often in winter / freezing weather. If the water/oil mixture in the catch can is allowed to freeze it will cause damage to the catch can and internal components. Any damage due to freezing is NOT WARRANTY. The purchaser or user of this product is responsible for the proper disposal of any hazardous materials (oil catch can contents). You must dispose of the liquid collected in the catch can properly (with used waste oil) according to your local laws.

Be sure to shop our online store for the best deals: www.uprproducts.com