

## UPR Oil Catch Can Installation

5030-98 / 5030-226 / 5030-156

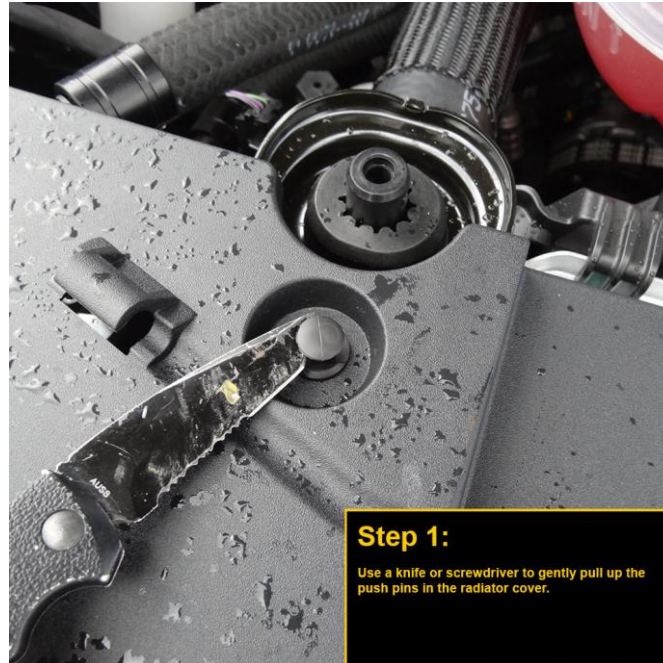

1. Use a knife, screwdriver or panel fastener tool to remove the push pins on the radiator cover. Remove the radiator cover for easier access to the catch can mounting location.



2. Locate the radiator support bracket on the passenger side front of the engine compartment. Use a 10mm socket to remove the bolt. Install the UPR bracket assembly in place of the factory bolt as shown. (GT350 will have a stud in this location. Remove the stud with a 5.5mm socket)

**Be sure to shop our online store for the best deals: [www.uprproducts.com](http://www.uprproducts.com)**



3. Most models will have a bulky wiring harness on the frame rail just below the catch can mounting location. You can reposition this harness slightly to clear the catch can if needed.
4. Mount the catch can to the bracket with the supplied knob.

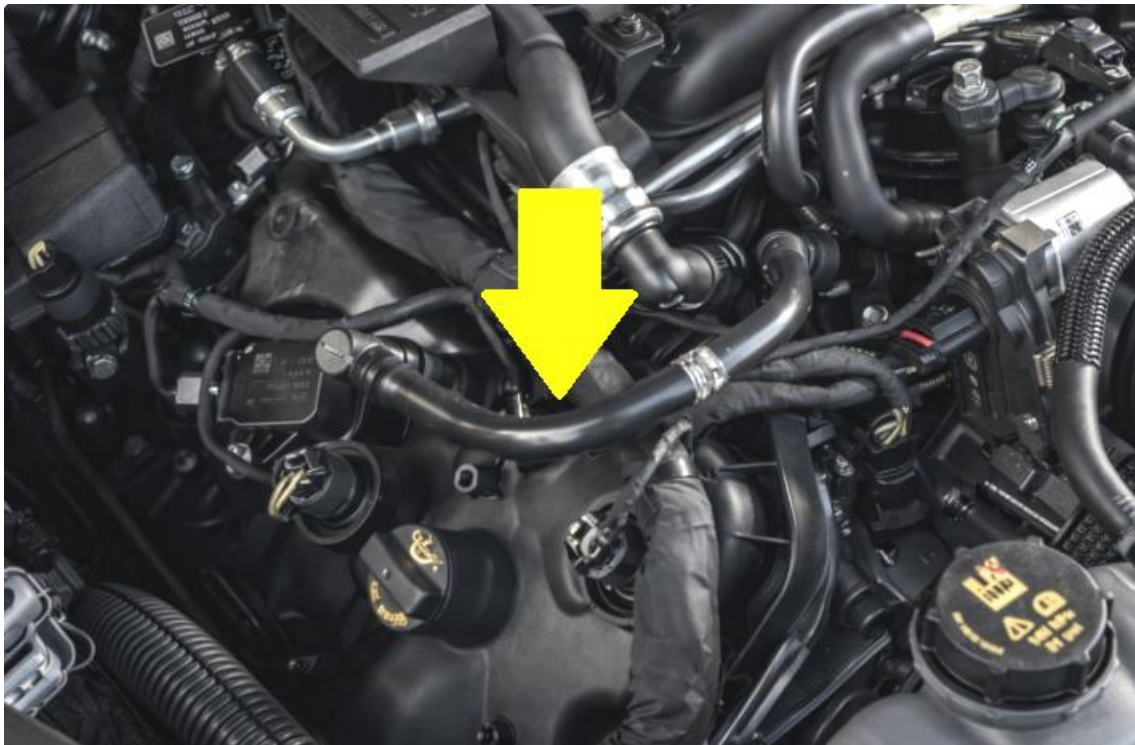

5. Locate the factory PCV hose that runs from the PCV valve on the passenger side valve cover to the intake manifold vacuum fitting just behind the throttle body. Remove this hose.



6. One long hose will have 90 degree fittings on both ends. This hose will connect from the top of the catch can to the PCV valve on the passenger side valve cover. The other hose in the kit will have a check valve in it. The hose should be installed so that the arrow printed on the check valve faces away from the catch can, towards the engine.

\*The fittings will click when fully engaged. To remove the fittings, press the grey buttons on the fitting. NEVER pry the buttons out of the fitting.

Check your catch can every 500 miles for the first few oil changes to get to know your vehicles Oil consumption. Never return collected oil back into the engine. Always check and drain the catch can more often in winter / freezing weather. If the water/oil mixture in the catch can is allowed to freeze it will cause damage to the catch can and internal components. Any damage due to freezing is NOT WARRANTY.

## Clean Side Separator (Optional)



If you selected to add the Clean Side Separator (CSS), It will connect to the driver side valve cover. Remove the driver side crankcase vent hose. It will run from the driver side valve cover to the air intake tube. Install the CSS onto the driver side valve cover by lifting up on the collar, and pushing it onto the fitting until it clicks. (*GT350 intake is pictured, other Mustang intakes will be similar. installation is the same.*)

*Product Liability Statement:* *The purchase of the product, manufactured by UPR Products Inc. completes an agreement between UPR Products Inc. and the customer. UPR Products Inc. assumes no liability for damages or injury incurred by the buyer of this product. The buyer has complete responsibility for the installation, use and upkeep of this product*